

A Tyco International Company

PG9984(P)/PG8984(P)/PG4984(P)

PowerG Wireless Dual Technology Mirror PIR Motion Detector Installation Instructions

Overview

The PG9984(P)/PG8984(P)/PG4984(P) are 2-way wireless PIR/ Pet immune motion detectors utilizing Target Specific Imaging™ to distinguish between human beings and pets weighing up to 18 kg (40lb) while reduces false alarms by using True Motion Recognition™. Built-in link quality indicators reduce installation time by eliminating the need for the installer to physically approach the control panel. The detectors also have combined Fresnel and cylindrical optics that reach up to 15 meters (49 ft) and are equipped with wall creep zone protection.

Note: Pet immunity feature has not been evaluated to UL 639 or ULC-S306-03 due to the feature not being addressed in either standard.

Device Setup

Caution! To be installed by service persons in indoor, non-hazardous locations only. Risk of explosion if battery is replaced by an incorrect type. Observe polarity when installing batteries. Dispose of used batteries according to the manufacturer's instructions and according to local rules and regulations. Batteries are to be replaced by service persons only.

Note: To ensure the continued operation of all wireless devices after performing a system default, a global upload of all wireless programming via DLS is recommended before defaulting the system. After completing the system default, download the wireless programming.

Legend

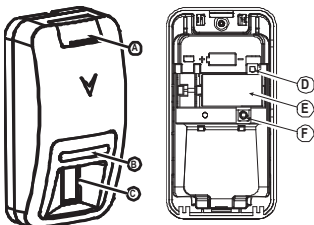

- A. Screw Cover
- B. LED
- C. PIR Optical window
- D. Enroll button (use a screwdriver to press the recessed button)
- E. Battery
- F. Tamper switch
- G. Horizontal view of coverage area
- H. Vertical view of coverage area
- I. Microwave coverage

Note: Back tamper switch is required for UL commercial burglary installations.

Install the battery

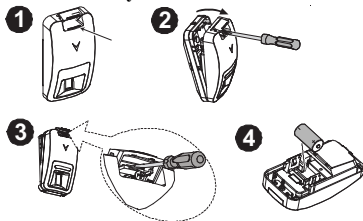

- On the indicated location, lift the screw cover upward using your thumb.
- Loosen the screw and open the cover in the direction shown by the arrow.

- Insert a screwdriver into the slot shown and then push downward to separate the base from the cover.
- Insert battery while observing polarity.

Note: When manually programming wireless devices, if a device has been powered up for more than 48 hours it cannot be enrolled into the system until the device has been tampered and restored. When programming the panel using the Quick Enroll procedure follow the steps detailed in Enroll the Device into the System.

Note: After restoring a low battery trouble the system may take up to 5 minutes to clear the trouble.

Enroll the Device into the System

To quick enroll:

- On a keypad press [*] [8] [Installer Code] [804] [000].
- Press and hold the device enroll button until the LED lights steady and then release the enroll button while the LED is still lit. A confirmation message then appears on the keypad.
- Press [*] key to confirm ID.
- Enter [3 digit zone #].
- Enter [3 digit zone type].
- Enter [1 digit partition #] for all desired partitions and press [#]. If using a menu based configuration you can scroll to the desired partitions and press [*] to toggle the partition.
- On an LCD keypad enter the label by using word library.

To pre-enroll:
1. Remotely configure the unique ID number into the system.
For more information see the HSM2HOST manual.

- When on-site, press the device enroll button.
- Note:** If the wireless device has been powered for more than 48 hours without being enrolled, tamper and restore the device to enroll it.

Perform a placement test

Note: Perform walktest at least once a year.
Before permanently mounting any wireless device, temporarily mount the device and perform a Placement test.

- Tamper the device by opening the cover.
- Restore the tamper. The device now enters Placement test mode for 15 minutes.
- Trip the device and the red LED blinks once to identify that a signal is being sent to the receiver and then blinks three times to identify the signal strength. To perform a walk test, walk across the far end of coverage pattern in both directions. The following table indicates received signal strength indication.

LED response	Signal Strength
Green LED blinks	STRONG
Orange LED blinks	GOOD
Red LED blinks	POOR
No blinks	No communication

IMPORTANT! Only GOOD or STRONG signal strengths are acceptable. If you receive a POOR signal from the device, relocate it and re-test until a GOOD or STRONG signal is received.

Note: For UL/ULC installations, only STRONG signal levels are acceptable. After installation verify the product functionality in conjunction with the compatible receivers HSM2HOST9, HS2LCDRF(P)9, HS2ICNRF(P)9 and PG9920.

Note: For detailed placement instructions refer to the control panel Reference Guide.

Mount the Device

The PowerG Series wireless PIR Motion detectors shall be installed and used within an environment that provides the pollution degree max 2 and overvoltages category II.

- Keep away from heat sources.
- Do not expose to air drafts.
- Do not install outdoors.
- Avoid direct sunshine.
- Keep wiring away from power cables.
- Do not install behind partitions.
- Mount on solid stable surface.

Installation Notes: Do not obscure the detector field of view with large objects, such as furniture. Install in position such that expected intruder motion is perpendicular to the zones of detection. Mount further than 5ft. from fluorescent light fixture employing two fluorescent tubes minimum rated 40 W.

Important! The PGx984 detector is immune to activity below 1 m (3ft) from 38 kg (85 lb) animals. Above the 1 m (3 ft) height limit, the detector is immune to 19 kg (42 lb) animals. Pet immunity decreases as the animal gets closer to the detector. Select a mounting location that minimizes potential close proximity of animals.

NOTE: Pet immunity feature has not been verified by UL/ULC. **WARNING!** To comply with FCC and IC RF exposure compliance requirements, the PIR detector should be located at a distance of at least 20 cm from all persons during normal operation. The antennas used for this product must not be co-located or operated in conjunction with any other antenna or transmitter.

To Mount the Device
Identify your mounting height and desired detector range. Using the table below determine if you are to use mounting holes x or y.

Note: Mounting flat or in a corner requires using different mounting holes. Mount using the supplied screws.

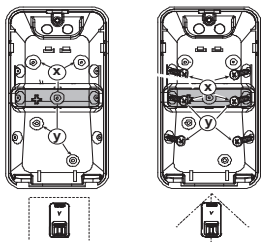

Height	Mounting Holes				Range
	6	9	12	15m	
10ft 3.0m					
9	y	y	y	y	
8	y	y	y	x	
7	y	y	x	x	
6	y	x	x	x	
	6	9	12	15m	
	15	30	45	60ft	

Configuration

To enter the wireless configuration section enter [804][Zone Number].

Device Toggles

[001][01] **Alarm LED - Default [Y]**
Enables the devices LED to activate when an alarm event occurs.

[001][04] **Supervision - Default [Y]**
Enables supervision of the device.

Selections

[003] **Hightraffic Shutdown - Default [01]**

Activating this feature helps conserve battery power when the system is disarmed by configuring a reporting timer. When motion is detected, the device transmits an alarm to the receiver and will not report any further events until the timer expires. Any motion detected during the configured period will be reported once the timer expires. No Delay causes the device to report an alarm each time the detector is tripped.

- [01] Detector Disarmed (while disarmed)
- [02] No Delay
- [03] 5 second delay
- [04] 15 second delay
- [05] 30 second delay
- [06] 1m delay
- [07] 5m delay
- [08] 10m delay
- [09] 20m delay
- [10] 60m delay

[016] Event counter - Default [002]

Alarm activates after a configured number of events have been detected.

Key in activities
001-002

LED Operation

LED Indications	Event
Red LED blinks	Stabilization (warm-up 60 sec)
Red LED on 0.2 sec.	Tamper open / close
Red LED blinks twice	One quad PIR detection in diagnostic mode
Red LED on 2 sec.	Intruder alarm
Yellow LED on	AM detection - Testing mode
Yellow LED blinks slowly (0.2 sec. ON, 30 sec. OFF)	AM detection - Normal mode

Specifications

GENERAL

Detector Type: Dual element low-noise pyroelectric sensor
Lens Data

No. of Beam Elements: 18x3=54 far parabolic mirror segments

No. of Curtain Elements: 18

MW Coverage

Maximum: 15 m (49 ft) / 90°

Medium: 10 m (33 ft) / 90°

Minimum: 5 m (16 ft) / 90°

Note: For UL/ULC listed installations the following settings are required:

MW coverage: Maximum

Event counter: High Sensitivity

Pet Immunity (PGx984P): Up to 18 kg (40 lb)

ELECTRICAL

Sensor Type: K Band Doppler module: 24 GHz

Internal Battery: 3V Lithium battery, type CR-123A consumer grade, UL or equivalent listed, RoHS compliant. Dispose of used batteries according to local regulations.

Note: For UL installations use Panasonic, Sanyo, GP or Varta only.

Nominal Battery Capacity: 1450 mA/h

Battery Life (for typical use): minimum one year, typical 5-8 years (not verified by UL/ULC)

Low Battery Threshold: 2.5 V

FUNCTIONAL

True Motion Event Verification: 2 remote selections - 1 (OFF) or 2 (ON) motion events

Verification Alarm Period: 2 seconds

WIRELESS

Frequency Band (MHz): CE Listed PG4984: 433MHz; CE/EN listed PG8984: 868MHz; FCC/IC/UL/ULC listed PG9984: 912-919 MHz

Communication Protocol: PowerG

Supervision: Signaling at 4-min. intervals

Tamper Alert: Reported when a tamper event occurs and in any subsequent message, until the tamper switch is restored

MOUNTING

Height: 1.8 - 3.0 m (6 - 10 ft)

Installation Options - Surface or corner

ACCESSORIES

PGBRACKET-1: Surface mounted swivel bracket, adjustable 30° down and 45° left/45° right.

PGBRACKET-2: PGBRACKET-1 with a corner adapter

PGBRACKET-3: PGBRACKET-1 with a ceiling adapter

Note: UL did not evaluate the product with the use of brackets.

ENVIRONMENTAL

RFI Protection: > - 20 V/m up to 2000 MHz, excluding inband frequencies

Temperature range: -10°C to +55°C (UL/ULC only verified the range 0°C-49°C)

Relative Humidity: up to max. 93%RH, non-condensing

PHYSICAL

Size (H x W x D): 115 x 60 x 48 mm (4-1/2" x 2-5/16" x 1-15/16")

Weight (with battery): 90 g (3oz).

Color: White

COMPATIBLE RECEIVERS

433MHz Band: HSM2HOST4; HS2LCDRF(P)4; HS2ICNRF(P)4; PG4920

868MHz Band: HSM2HOST8; HS2LCDRF(P)8; HS2ICNRF(P)8; PG8920

912-919MHz Band: HSM2HOST9; HS2LCDRF(P)9; HS2ICNRF(P)9; PG9920

Note: Only devices operating in band 912-919MHz are UL/ULC listed.

UL/ULC Notes

Only models PG9984, PG9984P operating in the frequency band 912-919MHz are UL/ULC listed. The PG9984, PG9984P has been listed by UL for commercial and residential burglary applications and by ULC for residential burglary applications in accordance with the requirements in the Standards UL 639 and ULC-S306 for Intrusion Detection Units.

For UL/ULC installations use these device only in conjunction with compatible DSC wireless receivers: HSM2HOST9, HS2LCDRF(P)9, HS2ICNRF(P)9 and PG9920. After installation verify the product functionality in conjunction with the compatible receiver used.

CE Europe: The PG4984/PG4984P and PG8984/PG8984P are compliant with the RTTE requirements - Directive 1999/5/EC of the European Parliament and of the Council of 9 March 1999. The

PG8984/PG8984P is certified to the following standards: EN50131-2-4, EN50131-1 GRADE 2, CLASS II, EN50131-6 Type C. Certification covers only the 868 MHz variant of this product. According to EN 50131-1:2006 and A1:2009, this equipment can be applied in installed systems up to and including Security Grade 2, Environmental Class II. UK: The PG8984 is suitable for use in systems installed to conform to PD6662:2010 at Grade 2 and environmental class 2 BSR243. The Power G peripheral devices have two-way communication functionality, providing additional benefits as described in the technical brochure. This functionality has not been tested to comply with the respective technical requirements and should therefore be considered outside the scope of the product's certification.

PG9984(P)/PG8984(P)/PG4984(P)

Instructions d'installation du détecteur de mouvement IPR, miroir, double technologie sans fil PowerG

Vue d'ensemble

Les PG9984(P)/PG8984(P)/PG4984(P) sont des détecteurs de mouvement IPR/insensibles aux animaux, bidirectionnels, sans fil, qui arrivent à faire la distinction entre des êtres humains et des animaux d'un poids de 18 kg (40lb) max. grâce à la technologie Target Specific Imaging™ tout en réduisant les fausses alarmes grâce à la technologie True Motion Recognition™. Les indicateurs de qualité de liaison intégrés réduisent les temps d'installation en supprimant la nécessité de l'installateur d'être physiquement à proximité de la centrale. Les détecteurs sont munis également d'optiques combinées cylindriques et de Fresnel qui atteignent une portée de 15 mètres (49 pieds) max. et possèdent une détection au ras du mur.

Remarque : La fonction d'insensibilité aux animaux n'a pas été évaluée pour les normes UL 639 ou ULC-S306-03 parce qu'elle n'est pas abordée par les deux normes.

Réglage du dispositif

