

IFAMPSU

1000W power supply module for Previdia Ultra control panels

1000W switching power supply module. It connects to the mains power supply and supplies a maximum 40A current to the system.

Provides a 3A battery-charger capable of maintaining under charge 17Ah, 24Ah or 38Ah batteries. It has two supervised outputs and a configurable relay output (at factory default configured as Alarm output, AUX output and fault signalling relay).

Accepts 230Vac or 115 Vac 50/60 Hz input

Only one power supply module can be housed inside each metal cabinet. Each control panel manages a maximum of 4 power supply modules (one for each eventual cabinet).

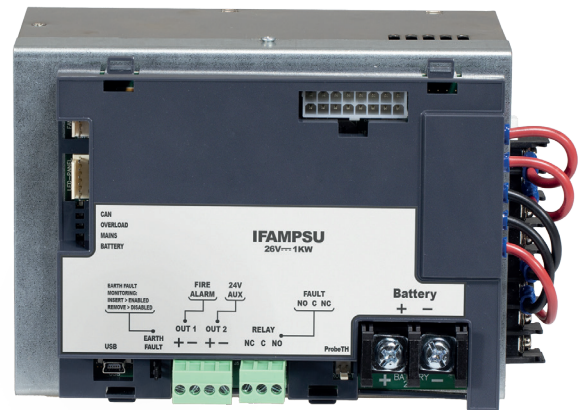

MAIN FEATURES

- 1000W power supply module (26V – 38A)
- Extended range mains voltage supply (115V ~ – 230V ~)
- Integrated battery charger
- Control and monitoring of batteries
- 2 supervised outputs and a relay output (preconfigured as alarm, AUX and fault respectively)
- Efficiency up to 94%
- It connects to the CAN DRIVE+ bar via a wire, leaving all 8 slots on the bar free
- Maximum 4 FPMPUSU modules per control panel (1 per cabinet)

TECHNICAL SPECIFICATIONS

Operating power supply voltage	230V~ (+10% - 15%) 115V~ (+10% - 15%) 50/60 Hz	
Maximum current draw from mains	5A @230V~ 8.5A @115V~	
Output voltage	26 V ^{nom} nominal +/- 10%	
Maximum output current ripple	200mV _{pp}	
Power factor	0.95 @ 230V ~ at full load 0.99 @ 115V ~ at full load	
Overvoltage protection	105 /135% of the declared potential (constant current limit, automatic reset to the reset of the overload conditions)	
Overload protection	29 / 33 V	
Overheating protection	Output voltage suspension, reactivation to reset temperature	
Maximum output current:	Total output of the power group (I _{max b} according to EN54-4)	38 A @ 230V~ 32 A @ 115V~
	Battery charger	3 A
	For external loads (I _{max a} according to EN54-4)	35 A@230V~ 29 A@115V~
	On each output (OUT1 and OUT2)	1.5A @27.6V ^{nom}
	On relay (RELAY)	5A, 30V ^{nom}
Consumption of batteries in the event of mains network failure		30 mA

HARDWARE SPECIFICATIONS

Relay output	1
Supervised configurable outputs	2
FW upgrade	via mini-USB port
Activity and status LED	4

MECHANICAL SPECIFICATIONS

Dimensions	250 x 137 x 123 mm	
Weight	2.3 Kg	
Casing cover	Enclosure material	Plastic
	Colour	RAL7015
	Flame class	UL 94 V-2
Box and base	Enclosure material	Metal

DIMENSIONS AND INSTALLATION

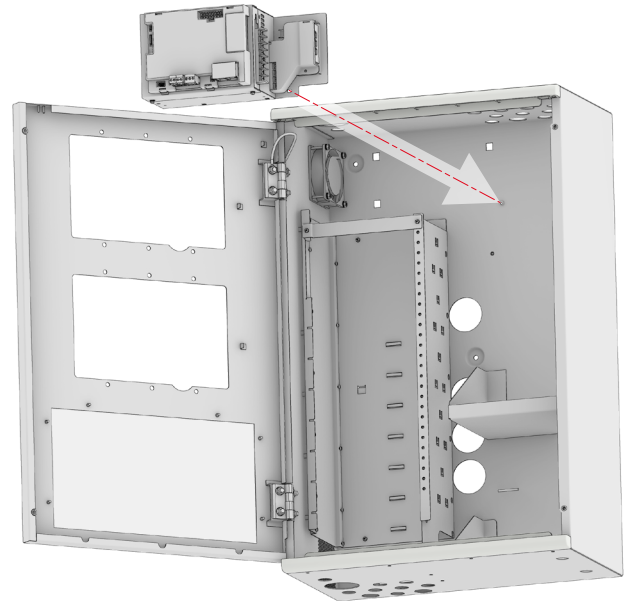
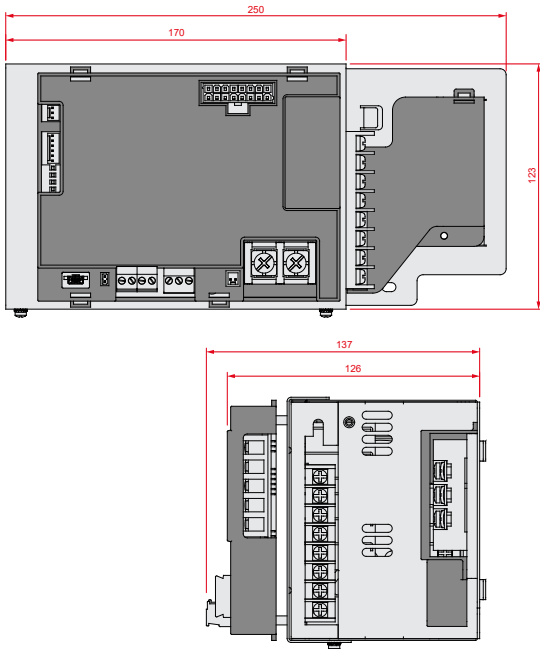

CONNECTIONS

Connection of non-polarized devices (sounders, etc.) o the OUT outputs

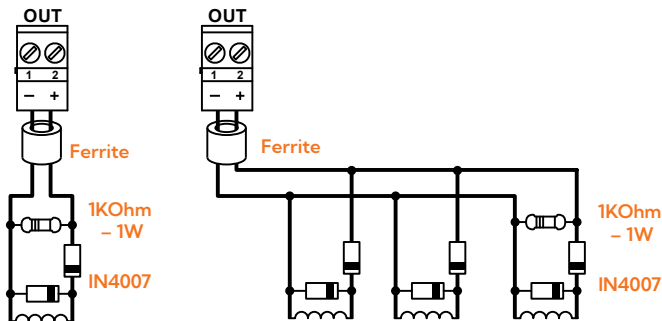

Connection of polarized devices (sounders, etc.) to the OUT outputs

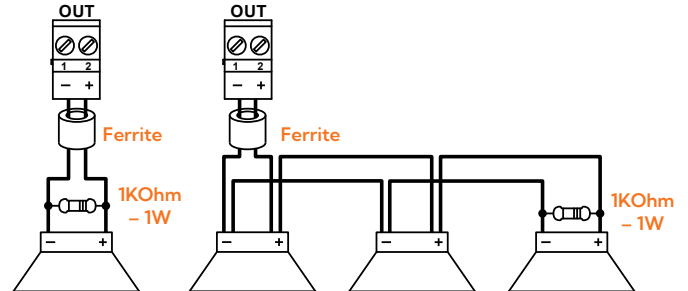

Connection of a generic device to the RELAY output

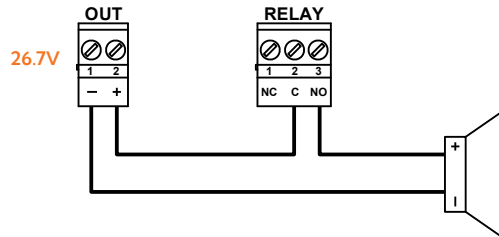

ORDER CODES

IFAMPSU

1000W switching power supply module for Previdia Ultra control panels (a module supplied already assembled in the Previdia Ultravox and Previdia Vox control panels)



Evolving Protection

Via Dei Laboratori 10
63076 Montepandone (AP) – Italy
Tel. (+39) 0735 705007 – Fax (+39) 0735 704912

info@inim.it – www.inim.it